

# S-1140/S-1240 Resilient seat gate valve DN 400/400-500

DIN F4 short/DIN F5 long

02-04/08.2010 **2**

Page 1 of 2

## Application and features

- Application: Water
- Wedge in rubber approved for drinking water
- Design pressure 48 bar
- Flexible solutions for manoeuvring
- Prepared for automation (electric motor, indication)
- Water lubricated sleeve bearings to reduce operation torque
- 1/4" manual bonnet air relief valve
- Replacable wedge guiding rails in non-corroding material (6 pieces) to prevent damage to rubber and surface treatment
- Service outlets (optional)
- DN 500 equals DN 400, with additional two pieces of 500 x 400 flanged reducers
- Clockwise closing
- GSK approved coating



## Technical description

- Design standards: DIN 3352-1/4, DIN 3840, ISO 7259, EN 1074, EN 1171
- Face-to-face length S-1140: EN558/ ISO 5752 series 14
- Face-to-face length S-1240: EN558/ ISO 5752 series 15
- Max. working pressure: PN 16, vacuum -0,8 bar
- Flange drilling: Standard drilling PN 10 (EN1092-2), PN 16 on request
- Max. temperature: 50°
- Test pressure open valve: 24 bar
- Test pressure closed valve: 21 bar
- Coating: Epoxy minimum 250 µm
- Product colour: Blue, RAL 5017
- Body/bonnet connection: Socket head bolts covered with wax
- Valve top: Prepared for spindle extension S-1880
- Stem: Non-rising with tapered stem end, according to DIN 87304 (see table)

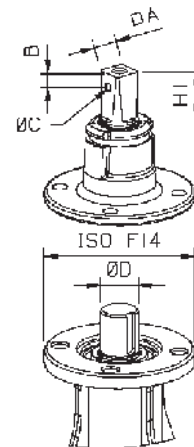

### Dimensions stem top:

DN 400

A	32
B	16
C	8
D	44
H1	55
H2	51

## References, dimensions and performances

Series	DN mm	Flange-drilling	H mm	L mm	Weight kg	Kv m <sup>3</sup> /h	Z	Esco no.
S-1140	400	PN 10	1053	310	285	16359	0,15	11400400
	400	PN 16	1053	310	285	16359	0,15	11400401
S-1240	400	PN 10	1053	600	443	16359	0,15	12400400
	400	PN 16	1053	600	443	16359	0,15	12400401
	500	PN 10	1053	700	450	25562	0,15	12400500
	500	PN 16	1053	700	450	25562	0,15	12400501

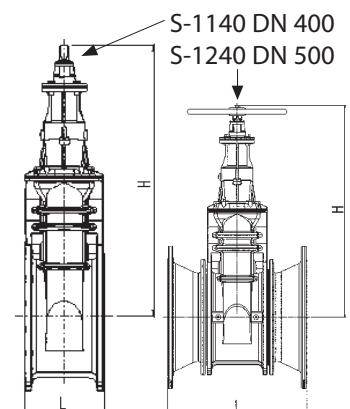

Kongsberg Esco AS can accept no responsibility for possible errors in catalogues, brochures and other printed material. Kongsberg Esco AS reserves the right to alter its products without notice. This also applies to products already on order provided that such alterations can be made without subsequent changes being necessary in specifications already agreed. All trademarks in this material are property of the respective companies. Kongsberg Esco and the Kongsberg Esco logotype are trademarks of Kongsberg Esco AS. All rights reserved.

# S-1140/S-1240 Resilient seat gate valve DN 400/400-500

DIN F4 short/DIN F5 long

02-04/08.2010 **2**  
Page 2 of 2

## Material specification

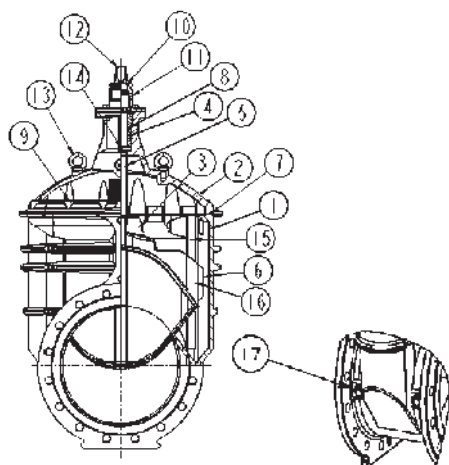

To be delivered on request

Pos	Detail	Materials
1	Body	Ductile iron EN 1563 EN-GJS-500-7
2	Bonnet	Ductile iron EN 1563 EN-GJS-500-7
3	Stem nut	Dezinkfree brass (DZR)
4	Stem bushing	Dezinkfree brass (DZR)
5	Stem	Stainless steel EN10088-3 1.4021
6	Wedge	Ductile iron EN1563 EN-GJS-500-7 with rubber
7	Gasket	Rubber approved for drinking water
8	O-rings	Rubber approved for drinking water
9	Socket head bolt	Steel 8.8
10	Dirt seal	Rubber (NBR)
11	Adapter	Ductile iron EN 1563 EN-GJS-500-7
12	Stem top	Stainless steel EN10088-3 1.4021
13	Lifting lug	Steel 8.8
14	Sleeve bearing	Composite
15	Guiding rail	Brass CC333G-GZ/GC
16	Guiding chip	Peek
17	Service outlet 1" (optional)	Brass
18	Air relief valve	Dezinkfree brass (DZR)

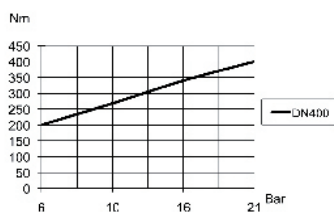

### Operating torque

DN	No. of turns	Bore in mm	Max operating torque
400	59	406	1000 Nm
500	59	406	1000 Nm

## Installation

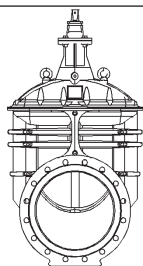

Recommended

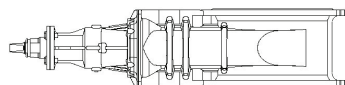

Possible

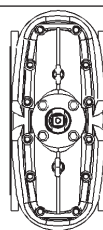

Possible

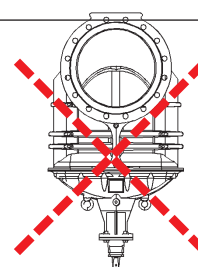

Not recommended

## Accessories and other variants

### Accessories:

- S-1120/S-1121 Norwegian cap
- S-1110 Handwheel
- S-1882 Spindle extension with indicator
- S-1895 Sleeve
- S-1830/S-1835/S-1840 Operating box

### Other variants:

- S-1140/S-1240 Clockwise closing DN 40-50
- S-1140/S-1240 Clockwise closing DN 65
- S-1140/S-1240 Clockwise closing DN 80-150
- S-1140/S-1240 Clockwise closing DN 200-300