

S-1155/S-1255 Resilient seat gate valve DN 200-300

DIN F4 short/DIN F5 long

02-07/1039002381/08.2009 **2**

Page 1 of 2

Application and features

- Application: Water and sewage
- Easy to assemble microswitch for remote control
- Design pressure 64 bar
- Especially robust stem in stainless steel
- Double o-rings
- rubber coated wedge
- Blow-out proof bonnet gasket
- Dirt seal



Technical description

- Pressure class: PN 16, clockwise closing, standard drilling PN 10 (EN1092-2)
- Standards: DIN 3352-1/4, DIN 3840, EN 1074
- Max. working temperature: 50°C.
- Test pressure: Open valve, 24 bar. Closed valve, 21 bar.
- Bonnet connection: Socket head bolts, recessed and covered with wax
- Stem: Non-rising. With tapered stem end
Pitch 1:20, see table
- Vacuum: -0,8 bar
- Approvals: DVGW (D), VdS (D)
- Face-to-face length: S-1155 - EN 558/ ISO 5752, series 14
S-1255 - EN 558/ ISO 5752, series 15
- Surface treatment: Epoxy average ca. 250 µm
Colour: Blue, RAL 5017

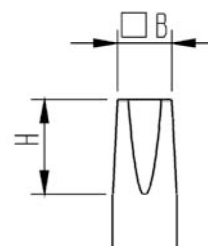

Dimensions stem top:

DN	B	H
200-300	24,3	42

References, dimensions, performances

Series	DN mm	H mm	L mm	R mm	Wht. kg	Kv m ³ /h	Z	Esco no.
S-1155	200	612	230	400	63	3960	0,15	11550200
	250	745	250		102	6188	0,15	11550250
	300	830	270		142	8910	0,15	11550300
S-1255	200	612	400	400	80	3960	0,15	12550200
	250	745	450		113	6188	0,15	12550250
	300	830	500		163	8910	0,15	12550300

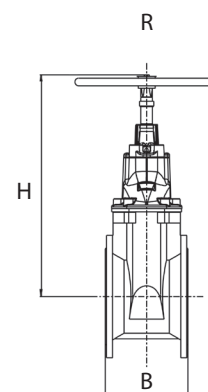

Kongsberg Esco AS can accept no responsibility for possible errors in catalogues, brochures and other printed material. Kongsberg Esco AS reserves the right to alter its products without notice. This also applies to products already on order provided that such alterations can be made without subsequent changes being necessary in specifications already agreed. All trademarks in this material are property of the respective companies. Kongsberg Esco and the Kongsberg Esco logotype are trademarks of Kongsberg Esco AS. All rights reserved.

S-1155/S-1255 Resilient seal gate valve DN 200-300

DIN F4 short/DIN F5 long

02-07/1039002381/08.2009 **2**

Page 2 of 2

Material specification

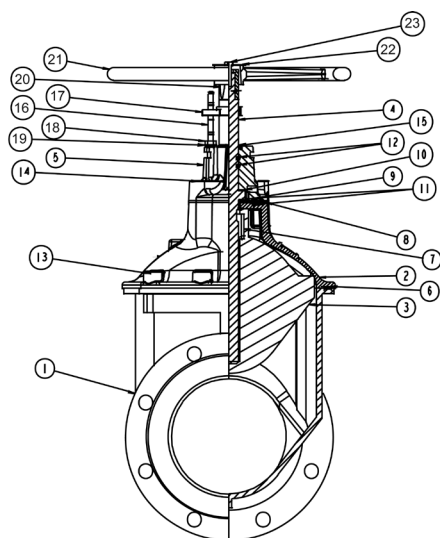

Material specification:

Pos	Detail	Materials
1	Body	Ductile iron EN 1563 EN-GJS-500-7
2	Bonnet	Ductile iron EN 1563 EN-GJS-500-7
3	Wedge	Ductile iron EN 1563 EN-GJS-500-7 w/rubber
4	Stem	Stainless steel EN10088-3 1.4021
5	Stuffing box	Avsinkingningsfri messing
6	Gasket	Rubber (NBR)
7	Stem nut	Brass CR
8	Socket head bolt	Steel 8.8
9	Sealing ring	POM
10	Sleeve bearing	Composit
11	O-ring	Rubber (NBR)
12	O-ring	Rubber(NBR)
13	Socket head bolt	Steel 8.8
14	Socket head bolt	Steel 8.8
15	Dirt seal	Rubber (NBR)
16	Indicator pin	Stainless steel EN 1088-3.1.4021
17	Direction indicator	Dezinkfree brass
18	Nut	Steel 8.8
19	Indicator	Steel 8.8
20	Spindletop	Stainless steel EN 1088-3.1.4021
21	Handwheel	GGG 1563 EN-GJS-500-7
22	Direction indicator	De-zincfree brass
23	Screw	Steel 8.8

Characteristics

Operation torque:

DN	Number of turns	Bore dia.	Max. torque
200	33	187	500 Nm
250	43	240	500 Nm
300	49	290	500 Nm

Installation

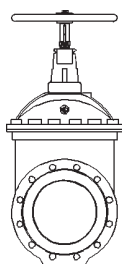

Recommended

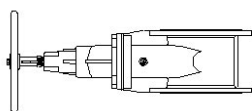

Possible

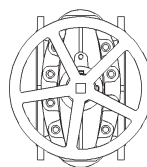

Possible

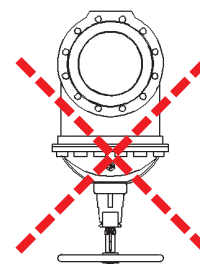

Not recommended

Accessories and other variants

Other variants:

- S-1161/S-1261 Prepared for actuator
- S-1160/S-1260 With electrical actuator
- S-1170/S-1270 With pneumatic actuator
- S-1140/S-1240 Without indicator