

# S-1155 Resilient seat gate valve DN 400

With indicator

02-08/1039000191/10.2009 **2**  
Page 1 of 2

## Application and features

- Application: Water and sewage
- Rounded shape to ensure smooth surface treatment
- ISO-flange for motorized or manual operation
- Repackable under pressure
- Manual bonnet air relief valve
- Replacable wedge guiding rails in non-corroding material (6 pieces) to prevent damage to rubber and surface treatment
- Service outlets (optional)
- Lifting lugs for easy handling and installation
- Easy to assemble microswitch for remote control
- Design pressure 48 bar
- VDS approved for PN 10



## Technical description

- Pressure class: PN 10, clockwise closing, standard drilling PN 10 (EN1092-2)
- Standards: DIN 3352-1/4, DIN 3840, EN 1074
- Max. working temperature: 50°C.
- Test pressure: Open valve, 24 bar. Closed valve, 21 bar.
- Bonnet connection: Socket head bolts, recessed and covered with wax
- Stem: Non-rising. With tapered stem end According to DIN 87304 (see table)
- Vacuum: -0,8 bar
- Face-to-face length: EN 558/ ISO 5752, series 14
- Surface treatment: Epoxy minimum 250 µm  
Colour: Blue, RAL 5017

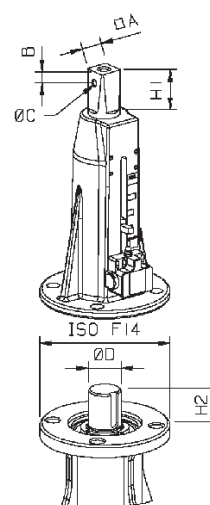

### Dimensions stem top:

DN 400

A	32
B	16
C	8
D	44
H1	55
H2	51

## References, dimensions, performances

Series	DN mm	H1 mm	L1 mm	Wht. kg	Kv m <sup>3</sup> /h	Z	Esco no.
S-1155	400	1220	310	297	16359	0,15	11550400

Other variants can be supplied to special order.

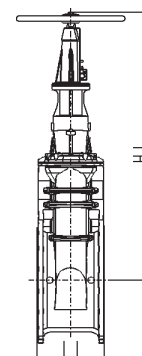

Kongsberg Esco AS can accept no responsibility for possible errors in catalogues, brochures and other printed material. Kongsberg Esco AS reserves the right to alter its products without notice. This also applies to products already on order provided that such alterations can be made without subsequent changes being necessary in specifications already agreed. All trademarks in this material are property of the respective companies. Kongsberg Esco and the Kongsberg Esco logotype are trademarks of Kongsberg Esco AS. All rights reserved.

# S-1155 Resilient seal gate valve DN 400

With indicator

02-08/1039000191/10.2009 **2**

Page 2 of 2

## Material specification

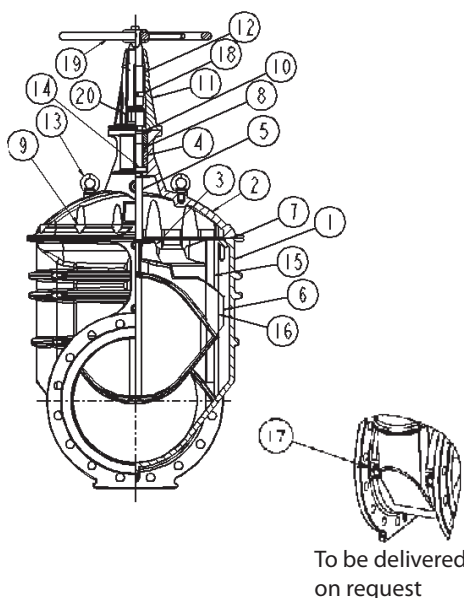

### Material specification:

Pos	Detail	Materials
1	Body	Ductile iron EN 1563 EN-GJS-500-7
2	Bonnet	Ductile iron EN 1563 EN-GJS-500-7
3	Stem nut	Brass CR
4	Stem bushing	Brass CR
5	Stem	Stainless steel EN10088-3 1.4021
6	Wedge	Ductile iron EN1563 EN-GJS-500-7 with rubber (NBR)
7	Gasket	Rubber (NBR)
8	O-ring	Rubber (NBR)
9	Socket head bolt	Steel 8.8
10	Dirt seal	Rubber (NBR)
11	Adapter	PUR
12	Stem top	Stainless steel EN10088-3 1.4021
13	Lifting lug	Steel 8.8
14	Sleeve bearing	Composite
15	Guiding rails	36G-GZ/GC
16	Guiding chips	Peek
17	1" Service outlet	Brass
18	Indicator	Brass
19	Handwheel	EN1561 EN-GJL-500-7
20	Microswitch	

## Characteristics

### Operation torque:

DN	Number of turns	Bore dia.	Max. torque
400	59	406,4	700 Nm

## Installation

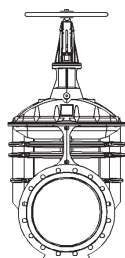

Recommended

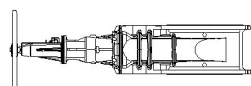

Possible

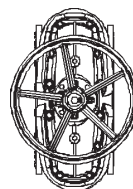

Possible

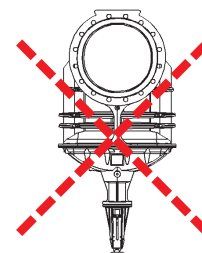

Not recommended

## Accessories and other variants

### Other variants:

Adapter with square stem top  
S-1160 With electrical actuator  
S-1161 Prepared for actuator