

S-2844-4, S-2844-9 Resilient seat gate valve Dy 200-315

For PE-pipes Dy 200-315

03-03/1039002761/06.2009 **3**
Page 1 of 2

Application and features

- Application: Water and sewage
- Pre-assembled - pullout resistant pipe-ends - ready for welding
- Highly fitted for embedment - no bolts in the ground
- Dirt seal on each socket end preventing dirt and sand from entering the sockets
- New insulated stem bushing, protected by a rubber dirt seal
- Elegant and safe lockable bayonet coupling system for spindle extension
- Highly sturdy stem in stainless steel
- GSK approved epoxy coating



Technical description

- Pressure class: PN 16, clockwise closing,
- Max. working temperature: 50°C
- Test pressure: Open valve, 24 bar. Closed valve, 17,6 bar
- Bonnet connection: Socket head bolts, recessed and covered with wax
- Stem: Non-rising with tapered stem end. Pitch 1:20 (see table)
- Standards: DIN 3352 1 and 14, DIN 3840, EN 1074, EN 1171,
- Vacuum: - 0,8 bar
- Coating: Epoxy minimum 250 µm
- Colour: Blue, RAL 5017
- PE-pipes: SDR 11* and SDR 17**
S-2844-4 **PE 100 PN 10, Dy 200-315
S-2844-9 *PE100 PN 16, Dy 200-315

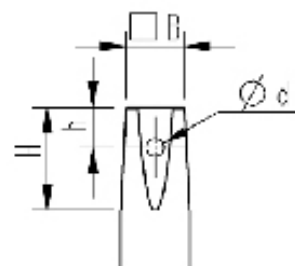

Dimensions stem top:

DN	B	H	h	d
200-300	27,3	47	18,5	8

References, dimensions and performances

Measures and references

Dy mm	DN mm	H mm	L mm	A mm	Vikt kg	Kv m ³ /h	Z	Esco nr. SDR11*	Esco nr. SDR17**
200	200	536	1074	184	70	3960	0,15	0028449200	0028444200
225	200	536	1154	186	78	3960	0,15	0028449225	0028444225
250	250	639	1234	217	108	6188	0,15	0028449250	0028444250
280	250	639	1244	221	116	6188	0,15	0028449280	0028444280
315	300	720	1254	237	155	8910	0,15	0028449315	0028444315

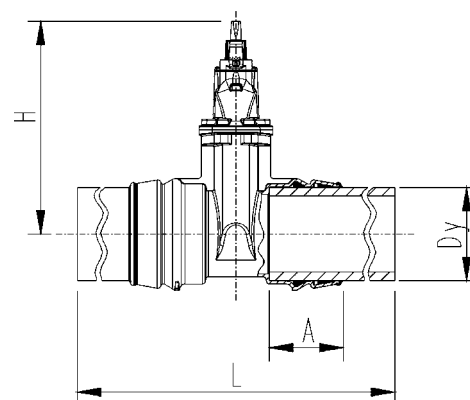

Kongsberg Esco AS can accept no responsibility for possible errors in catalogues, brochures and other printed material. Kongsberg Esco AS reserves the right to alter its products without notice. This also applies to products already on order provided that such alterations can be made without subsequent changes being necessary in specifications already agreed. All trademarks in this material are property of the respective companies. Kongsberg Esco and the Kongsberg Esco logotype are trademarks of Kongsberg Esco AS. All rights reserved.

S-2844-0 Resilient seat gate valve Dy 200-315

For PE-pipes Dy 200-315

03-03/1039002761/06.2009 **3**
Page 2 of 2

Material specification

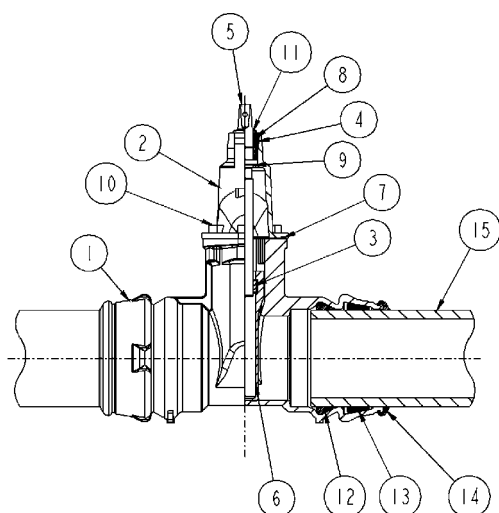

Pos	Detalj	Materialer
1	Body	Ductile iron EN1563 EN-GJS-500-7
2	Bonnet	Ductile iron EN1563 EN-GJS-500-7
3	Stem nut	Brass CR
4	Stem bushing	Brass CR
5	Stem	Stainless steel EN10088-3 1.4021
6	Wedge	Ductile iron EN1563 EN-GJS-500-7
7	Gasket	Rubber (NBR)
8	O-rings	Rubber (NBR)
9	Axial sleeve bearing	Composite
10	Socket head bolts	Steel 8.8
11	Dirt seal	Rubber (NBR)
12	Sealing rings w/with support	EPDM/PTFE
13	Locking ring	POM (Polyacetal)
14	Dirt seal (optional)	Rubber (NBR)
15	PE-pipe	PEH

Monteringsmuligheter

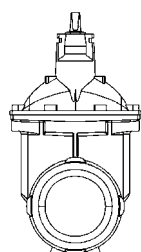

Recommended

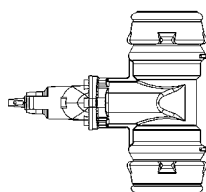

Possible

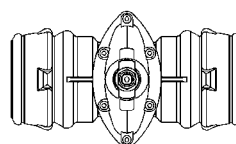

Possible

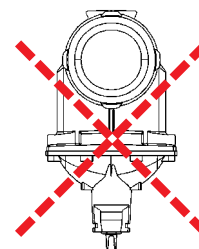

Not recommended

Accessories and other variants

Accessories:

S-1119 Italian cap
S-1120/1121 Norwegian cap
S-1122 Swedish cap
S-1123 English cap
S-1124 French cap
S-1110 Handwheel

S-1850 Spindle extension
S-1880 Spindle extension
S-1882 Spindle extension w/indicator
S-1830/1835/1840 Operating box

Other variants:

Prepared for actuator
With electrical actuator
With pneumatic actuator
With indicator
S-2845 Counterclockwise closing