

## S-2815 Anchor bend

Accessory for flanged socket and socket end gate valve

03-07/1039000761/01.2007 **3**  
Page 1 of 1

### Application and features

- Accessory for: S-9160/S-8282 Flanged socket, and S-2840 Resilient seat gate valve socket end.
- Used in connection with fastening of hard plastic pipes, where mounting of socket-/spigot end occurs.



### References, dimensions and performances

Dy	Weight kg	L	H	H1	Esco no.	NRF no.
90	3,0	103	150	105	28150090	206 0349
110	3,6	110	170	125	28150110	206 0353
160	7,2	145	230	180	28150160	206 0356
225	12,1	170	305	245	28150225	206 0359

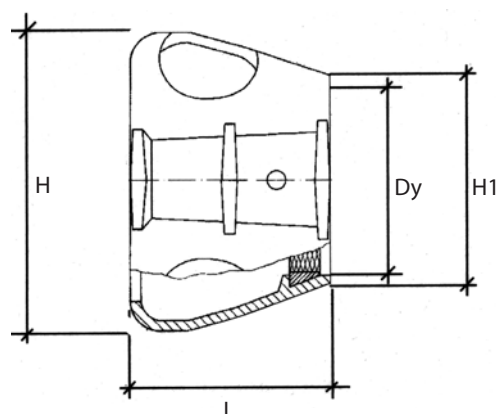

### Material specification

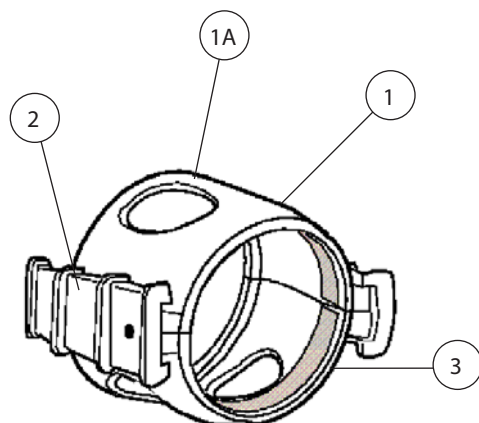

#### Material specification:

Pos	Detail	Materials
1	Body	Ductile iron EN1563 EN-GJS-500-7
1A	Surface treatment	Epoxy average ca. 250 µm
2	Wedge lock	Ductile iron EN1563 EN-GJS-500-7
3	Retaining ring	Brass SS 5170

Kongsberg Esco AS can accept no responsibility for possible errors in catalogues, brochures and other printed material. Kongsberg Esco AS reserves the right to alter its products without notice. This also applies to products already on order provided that such alterations can be made without subsequent changes being necessary in specifications already agreed. All trademarks in this material are property of the respective companies. Kongsberg Esco and the Kongsberg Esco logotype are trademarks of Kongsberg Esco AS. All rights reserved.